

cellQART® Cell Culture Inserts pre-loaded in Well Plates

User guide

cellQART®

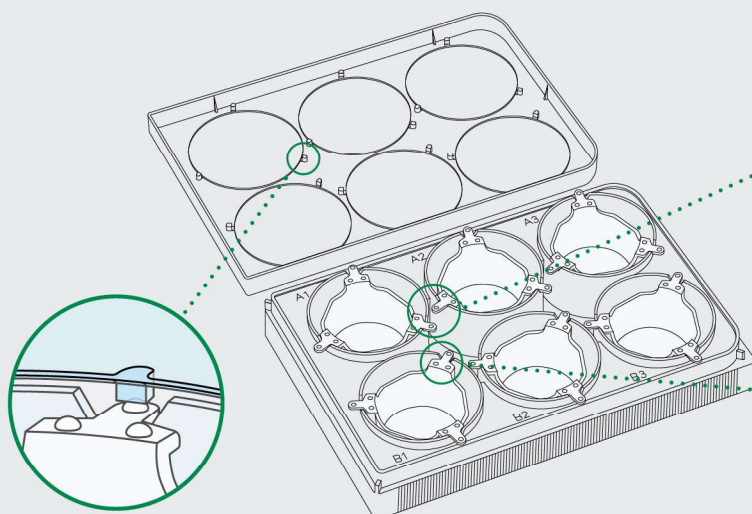

Lid with distance holders dedicated to keep proper oxygen exchange and fixed position during transportation.

11° rotated positioning design to prevent from overlapping and cross-contamination.

Deep placement of Insert arms to prevent from unwanted Insert movement during pipetting.

Stable positioning, wide window and lowered top edge for comfortable handling and pipette access.

Scope of application

cellQART® Cell Culture Inserts combined with our especially designed Well Plates are intended to be used for cell culture and *in vitro* tissue culture research applications.

cellQART® Well Plates are pre-loaded with cellQART® Cell Culture Inserts. Our cellQART® Cell Culture Inserts come with tissue culture treated PET membranes in translucent, clear extended culture or clear optics in 6-, 12- and 24-Well format. Well Plates and Inserts are supplied sterile.

Product dimensions

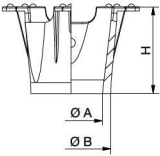
	6-Well Insert	12-Well Insert	24-Well Insert
Ø A = Inner diameter	23.9 mm	11.9 mm	6.4 mm
Ø B = Outer diameter	26.9 mm	14.9 mm	9.4 mm
↑ H = Height	16.3 mm	16.3 mm	16.3 mm
Growth area	4.5 cm ²	1.1 cm ²	0.3 cm ²
Working volume Insert	1–4 ml	0.2–0.8 ml	0.1–0.4 ml
Working volume Well	2–4 ml	0.9–1.8 ml	0.6–1.5 ml
Well Plate (with lid)	23.1 x 127.76 x 85.48 mm (H x W x D)		
Distance from Insert bottom to well bottom = 1 mm			

Materials

Membrane component:	Polyester (PET)
Plastic components:	Polystyrene (PS)

Notice

Please visit our website (www.cellQART.com) for the latest and most up-to-date information. The information provided in this document herein is subject to change at any time without notification. This document does not commit SABEU in any way. SABEU is not responsible for any errors that may appear in this document.

Product characteristics

The mutually optimized design of our Well Plates and Cell Culture Inserts pre-loaded in Well Plates offers the following advantages:

- Stable positioning of the Inserts within the wells
- Simplified pipetting by reduction of handling efforts
- Flexibility to integrate with automated workflows (e.g. 3D printing)
- Reduction of unwanted mechanical forces on cells caused by Insert shifting
- The design facilitates TEER electrode positioning
- Prevention of unwanted Insert movement during transportation
- Lid with condensation rings to prevent from cross-contamination
- Optimized gas exchange by product design (lid with distance holders, Inserts with lowered top edge and embossed spots on arms)
- Compatible with most standard cell culture equipment
- RNase/DNase free and non-pyrogenic
- Industry's leading quality standards to ensure 100% membrane parameter consistency and reproducible cell culture results
- Certified in accordance with DIN EN ISO 9001, DIN EN ISO 13485 and ISO class 8 cleanroom classification

User guidelines

- ✓ All products are for research use only and not intended for use in diagnostic or medical applications.
- ✓ Verify that blister, Insert & membrane are undamaged before use.
- ✓ Be careful not touching or damaging the membrane.
- ✓ Keep products away from strong acids, strong caustic solutions and organic solvents.
- ✓ All products are for single use only.

cellQART® Cell Culture Inserts pre-loaded in Well Plates

User guide

Our cellQART® Cell Culture Inserts come with tissue culture treated PET (Polyester/Polyethylene Terephthalate) membranes, are gamma sterilized and are available in various optical versions:

Clear PET	Clear extended culture PET	Translucent PET
Clear PET membranes enable superior optical transparency for visualization of cells by using phase contrast/bright field microscopy.	Clear extended culture PET membranes have the optimal pore density to support long term cultures. These membranes allow for monitoring by using phase contrast/bright field microscopy.	Translucent PET membranes have a high pore density. This allows for maximum diffusion of materials between the Cell Culture Insert and receiver Plate.

Explore the cellQART® portfolio in our webshop



Pore size	Pore density by membrane optics			Well size	Format
	Clear	Clear extended culture	Translucent		
0.4 µm	2 × 10 ⁶ pores per cm ²	4 × 10 ⁶ pores per cm ²	100 × 10 ⁶ pores per cm ²	6-Well	Single Insert
1.0 µm	2 × 10 ⁶ pores per cm ²	–	2 × 10 ⁶ pores per cm ²	12-Well	Fully pre-loaded Well Plate
3.0 µm	0.6 × 10 ⁶ pores per cm ²	–	2 × 10 ⁶ pores per cm ²	24-Well	Half pre-loaded Well Plate
5.0 µm	0.6 × 10 ⁶ pores per cm ²	–	0.6 × 10 ⁶ pores per cm ²		Empty Well Plate
8.0 µm	0.1 × 10 ⁶ pores per cm ²	–	0.2 × 10 ⁶ pores per cm ²		

Product specific information printed on the blister label.